

INSTALLATION GUIDE

797XX SERIES

FIBER TERMINATION UNIT

STEP 1 - MOUNTING BASE PLATE

- Place base plate (part 1) at the fiber tube entrance, the base plate can be mounted on the wall in any direction
- Use 4x plugs for 4mm screws, the screws embedded the package is for device assembly.

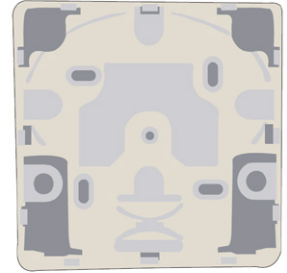

STEP 2 - FASTEN FIBER TUBE

- Fiber tube can be inserted from the back or from the sides, entrance can optionally be done via break-aways.
- Use tube fasten holder, and fasten tube with a plastic strip.

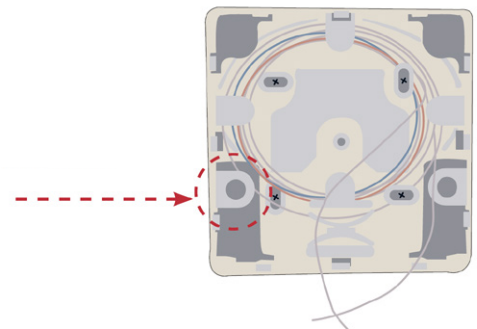

STEP 3 - SPLICING OF FIBERS

- The fibers can be spliced with the two embedded pigtailed
- Pay attention to the pigtail type, 1x SC/PC and 1x SC/ACP pigtailed.

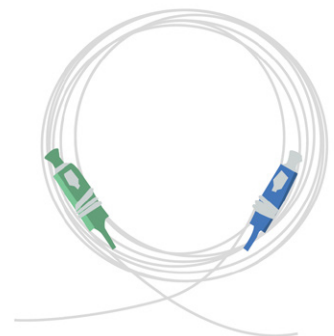

STEP 4 - SPOOLING OF FIBERS

- 2x Fiber Splice holders can be used to anchor the fiber optical splice sleeves
- The spool can be used to anchor the fibers, pay special attention to fiber bending radius (G.657A)

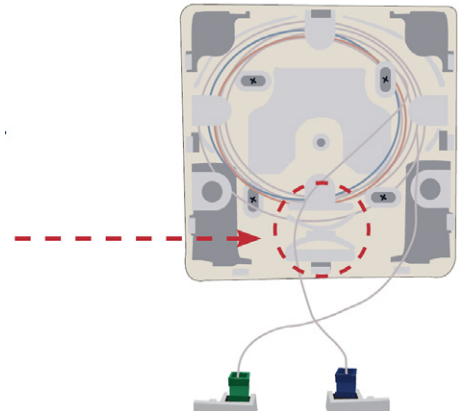
**STEP 5 - FASTEN PIGTAIL ADAPTERS**

- The SC/PC and SC/APC connectors on the fiber pigtails must be fastened in the fiber adapter holder piece (part 2)
- Click fiber adapter holder piece onto base plate
- Pay attention to correct connector and adapter type, and special attention to fiber bending radius (G.657)

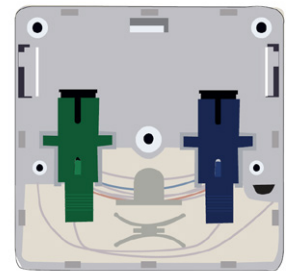
**STEP 6 - SECURE FIBERS AND ADAPTERS**

- Click adapter cover piece (part 3) onto base plate and fiber adapter holder piece
- 2x 4 mm screws can optionally be used for fastening of the adapter cover piece

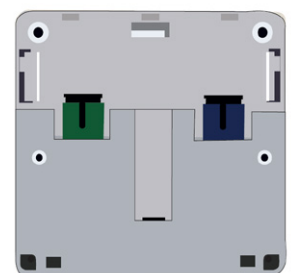

STEP 7 - FASTEN LOCKING MECHANISM PIECE

- 3x 4mm screws must be used for fastening of the locking mechanism piece (part 4)

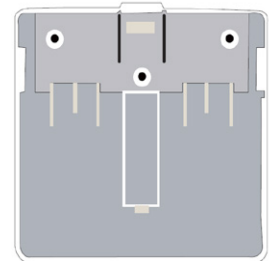

STEP 8 - FASTEN DUST COVER

- Place dust top cover top cover on the slides available on the fiber adapter holder piece

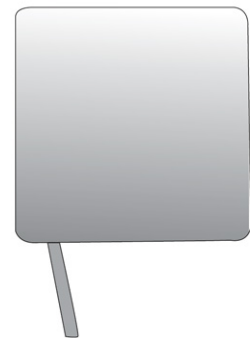

STEP 9 - REMOVAL OF DUST COVER

- The dust cover can be removed, and as an option this piece can be used for connection of external patch cords, via break-aways

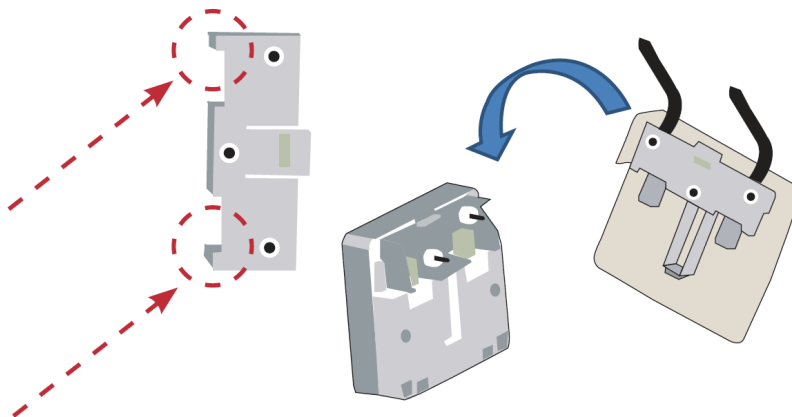

STEP 10 - ATTACH ACTIVE UNIT

- Make sure to remove protection covers on the SC/PC adapters as well as on the active unit pigtails, before clicking the units together

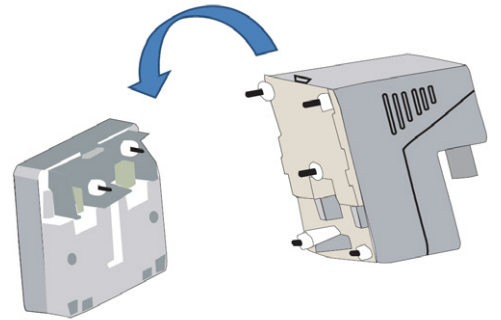

STEP 11 - CONNECT POWER ADAPTER

- Connect power adapter to the active unit and to 230VAC
- Insert RJ-45 LAN cable for connectivity to home gateway

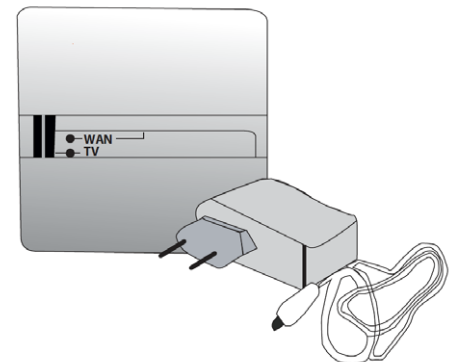

STEP 7 - FASTEN LOCKING MECHANISM PIECE

- Top LED: CATV link, LED on when signal is better than -10dBm, LED off when signal is less than -10 dBm
- Bottom LED: WAN fiber link, LED on when link
- LAN port LED: left and right LED on when link (blink = activity), note 10Mbps only left LED on

